

Rear Drawbar Assembly

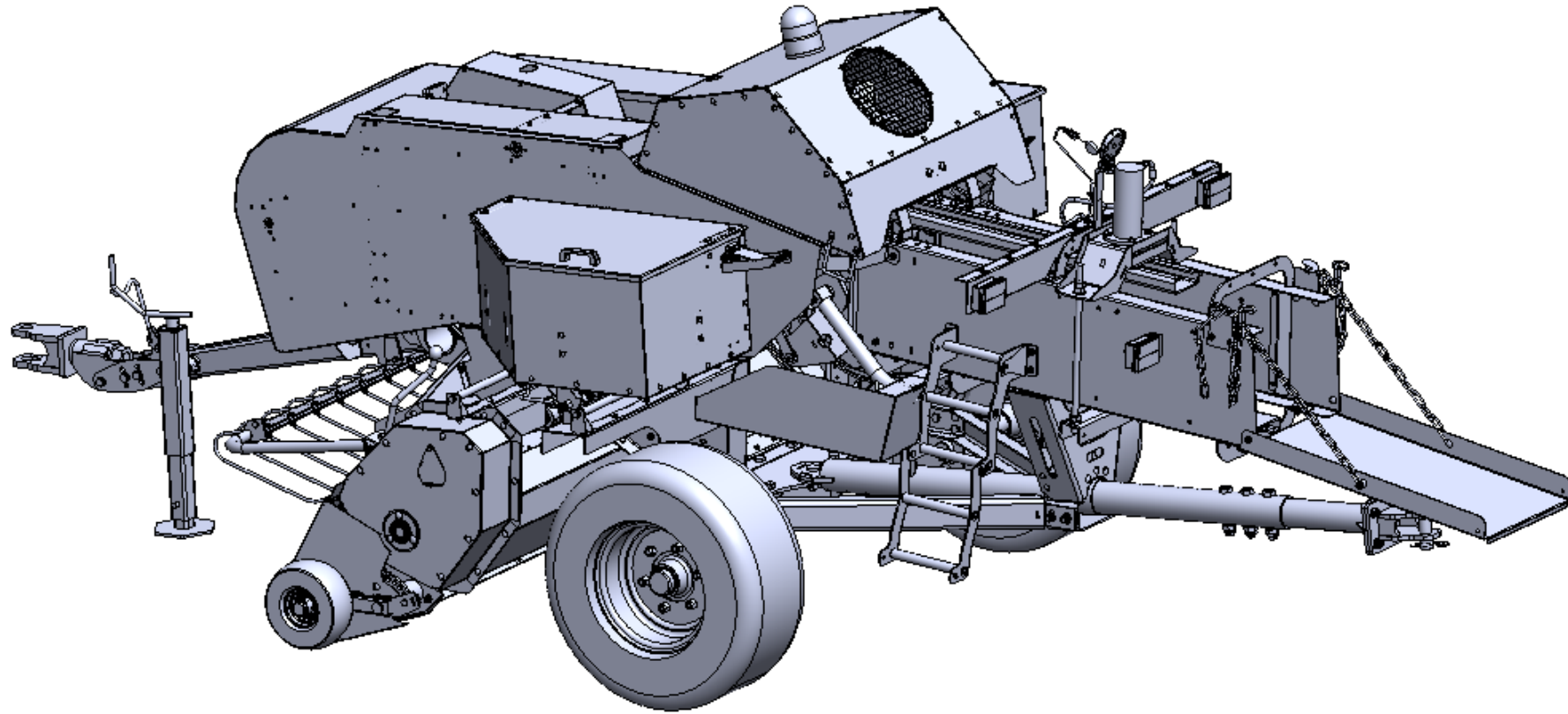

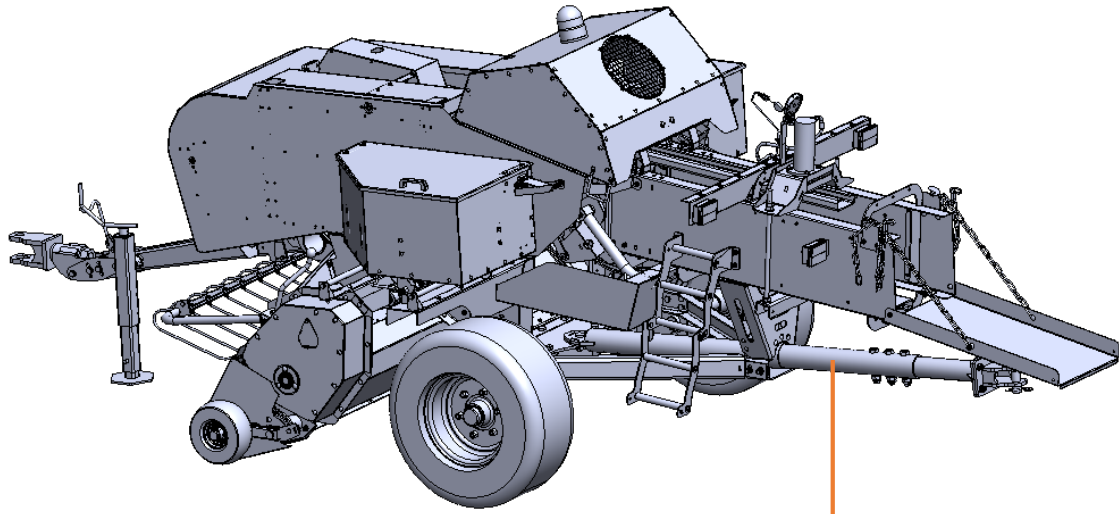

Figure 1

Rear Drawbar

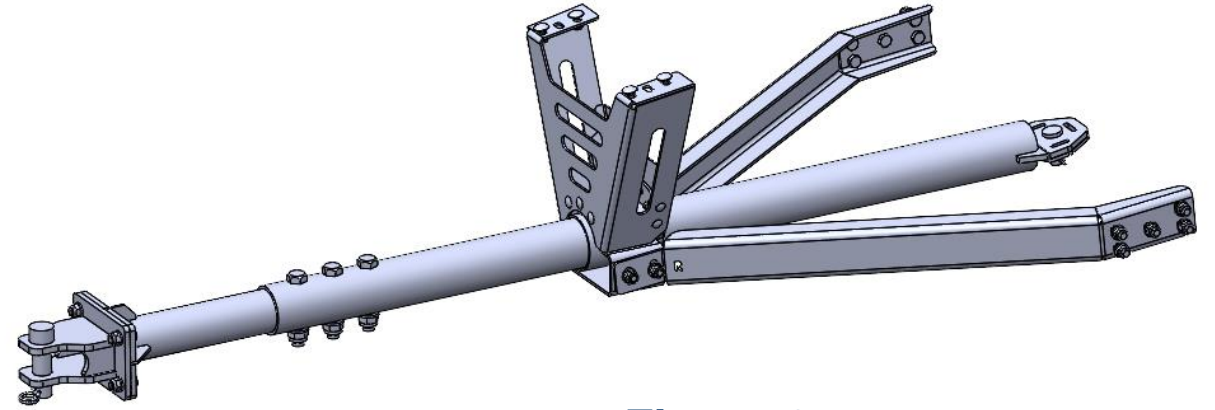

Figure 2

Rear Drawbar is assembled in the machine as shown in the figure 1.

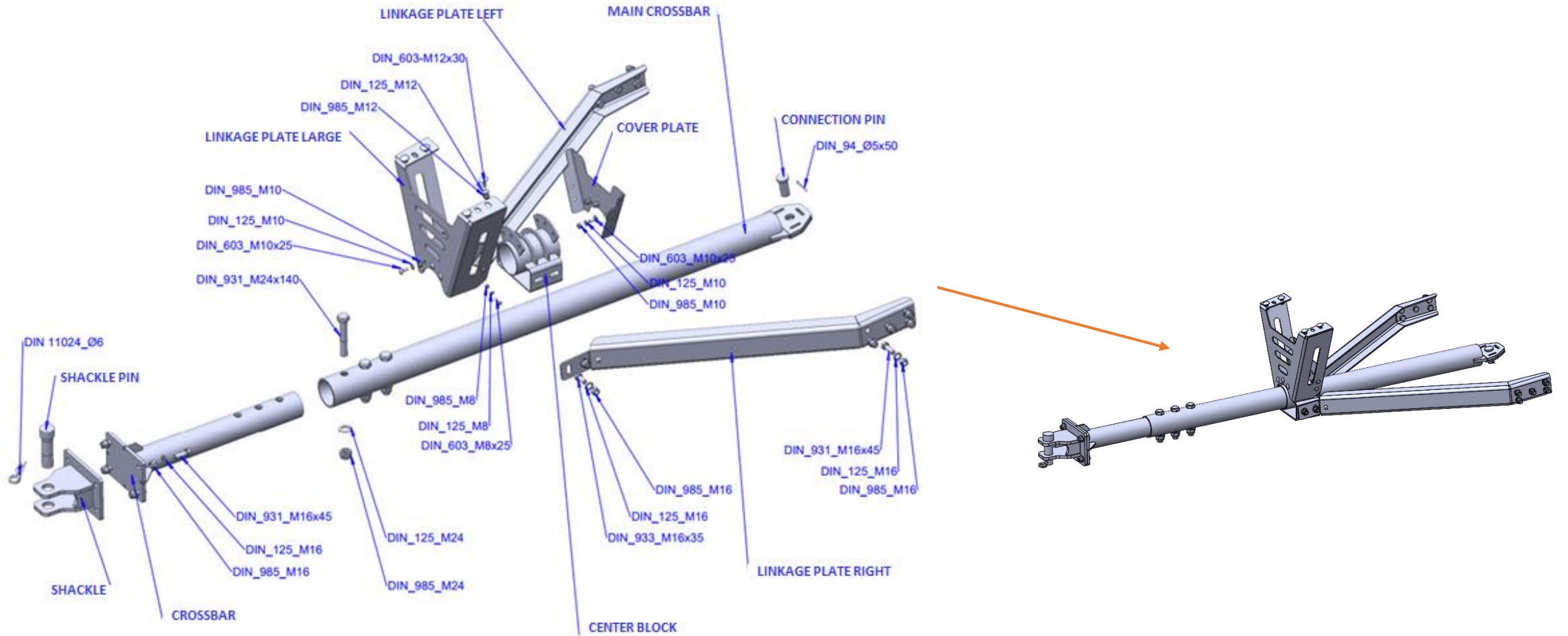
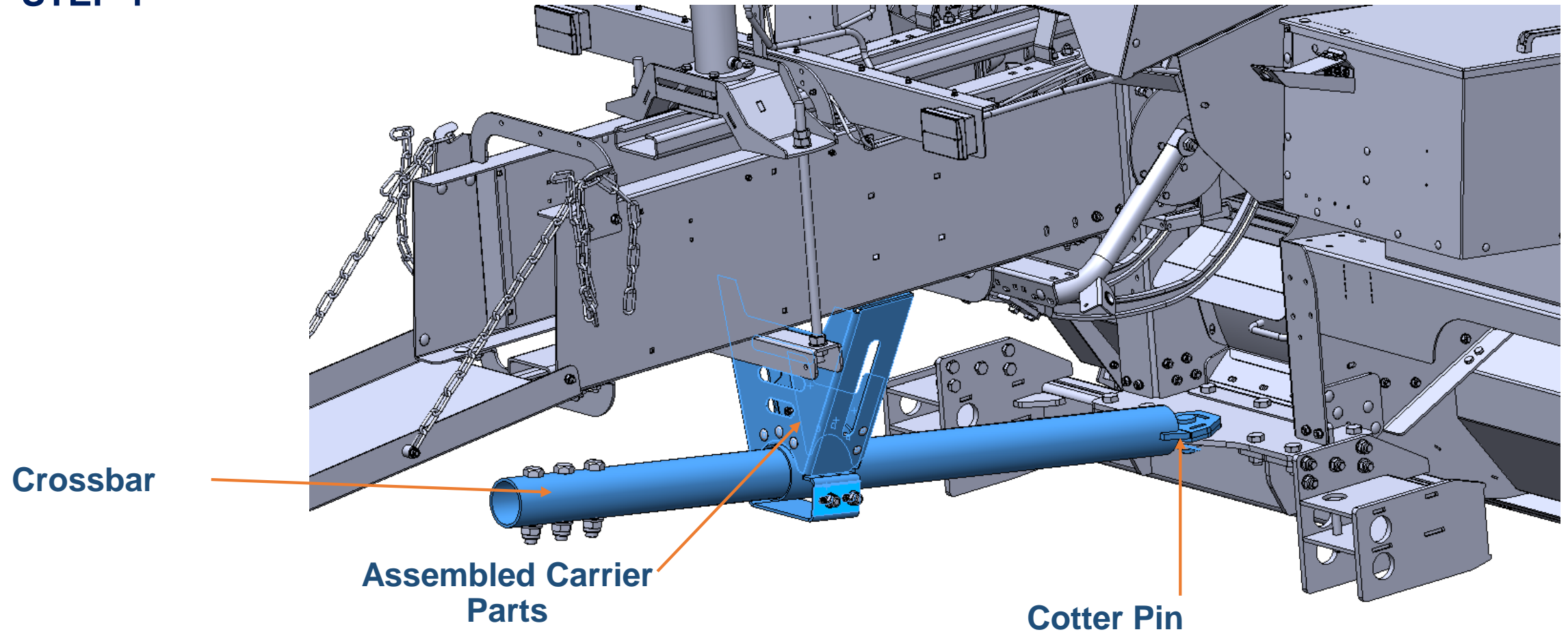

FIGURE 3

Rear Drawbar is consisting of the connection parts shown in the figure.

STEP 1



Crossbar is fixed along with the shackle pin to the mentioned place as shown in the figure and locked the cotter pin. Assembled carrier parts is mounted and crossbar is passed through as shown.

STEP 2

Bale Chamber
Plate

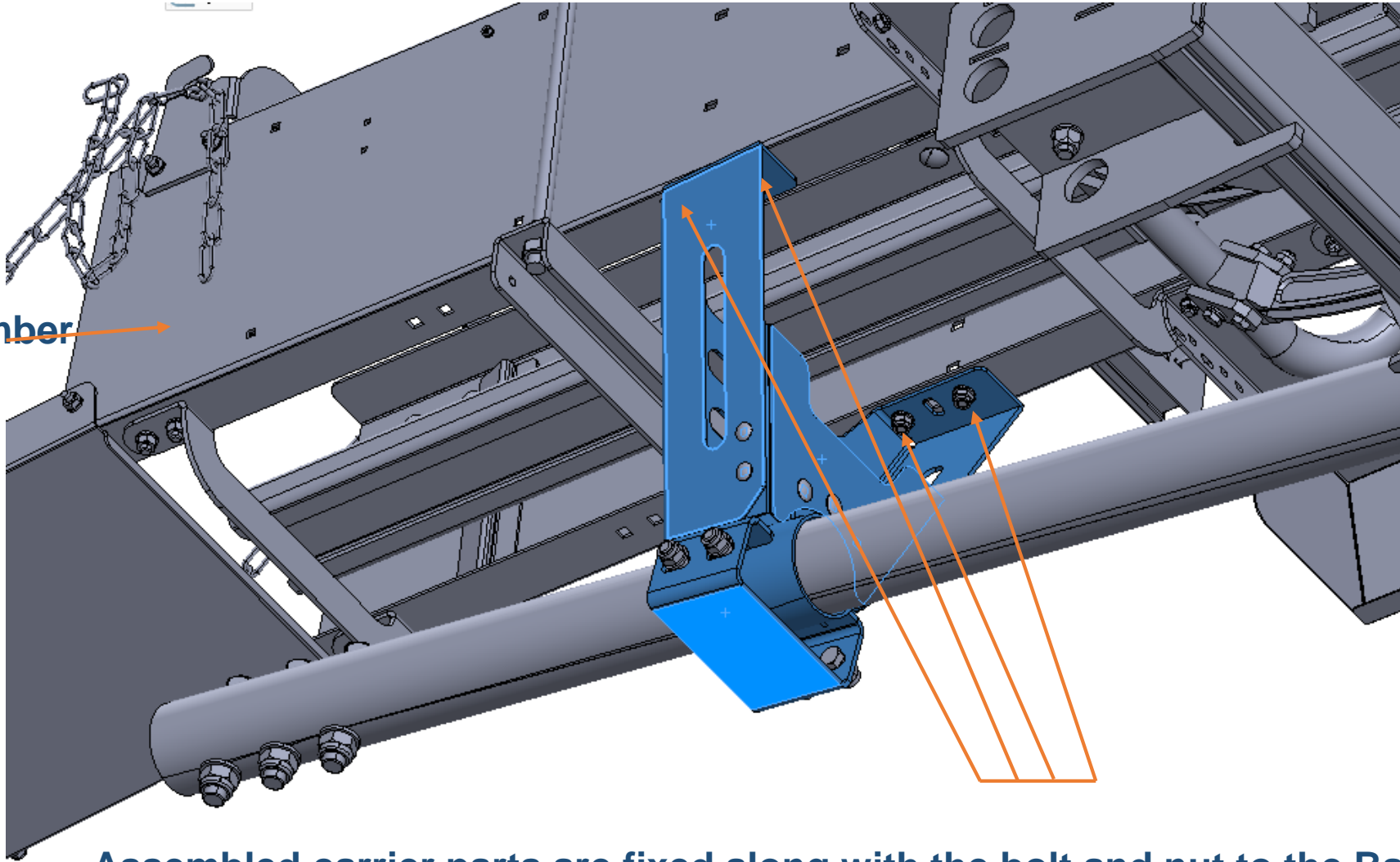

Assembled carrier parts are fixed along with the bolt and nut to the Bale Chamber Plates.

STEP 3

Shackle

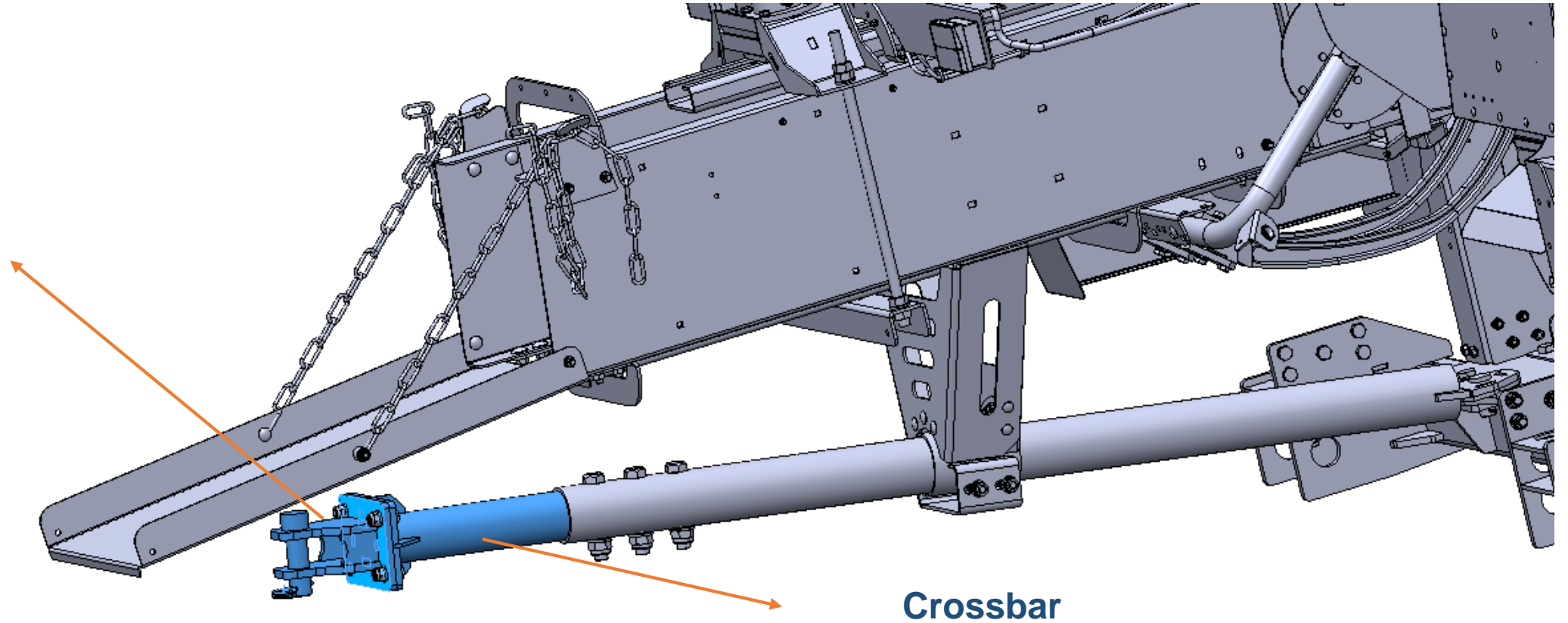

Crossbar

Shackle is fixed to the crossbar along with the bolt and nut as shown in the figure.

STEP 4

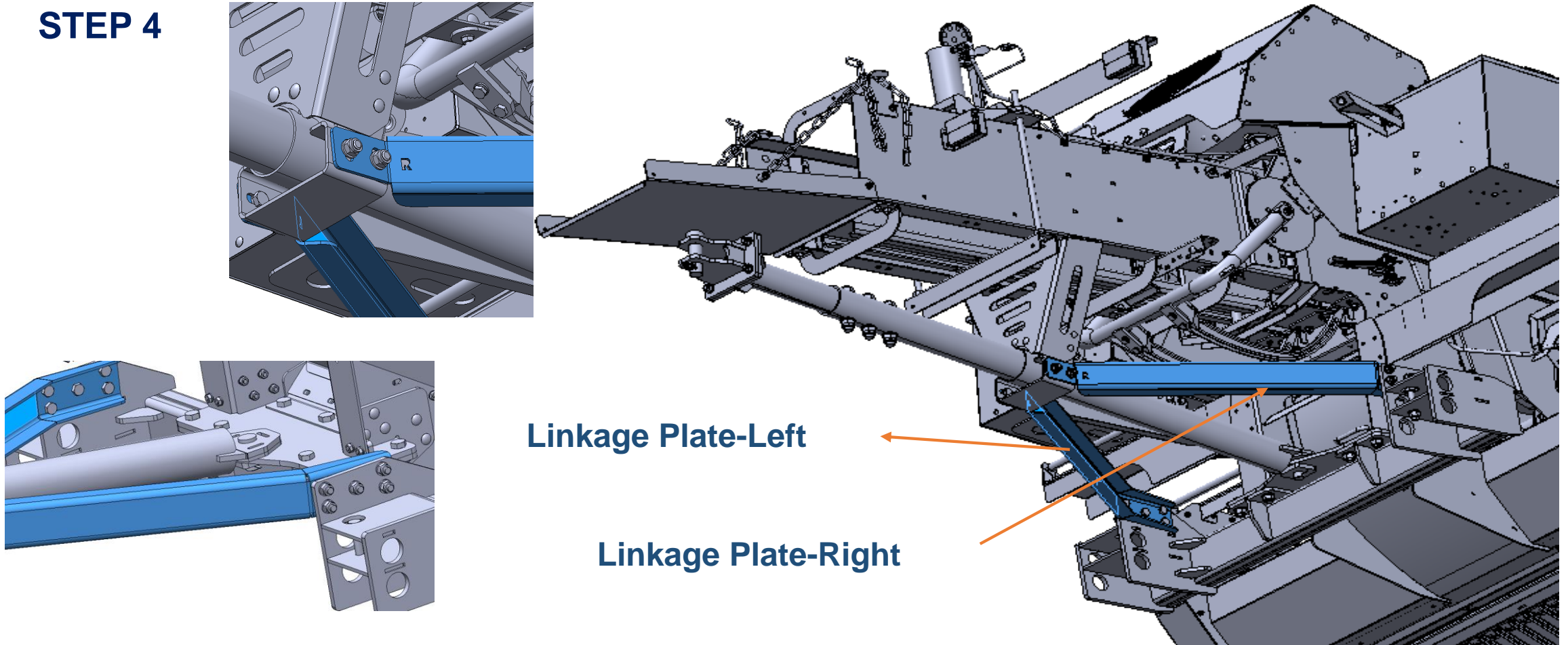

Linkage Plate-Left

Linkage Plate-Right

While looking the machine from the rear, Linkage Plates Left and Right are mounted as shown in the figures. R right – L Left indicators are on the plates.