

9032

Assembly instructions

Edition	9.2008
Date of print	7.2008
Language	EN
Implement number	6589-2501
Type	6589
Document number	VF16645580.EN

Kverneland Group Gottmadingen N. V.
Filiale Gottmadingen
Industriepark 312
78244 Gottmadingen
Germany
Tel.: +49 7731 788 - 0

Mounting Instructions

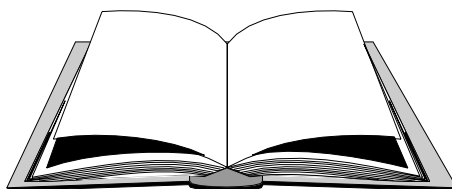

Read and follow exactly the safety instructions in chapter 1 before beginning to assemble the machine. Please observe the tightening torques listed in the table at the end of these instructions when assembling the machine. Torques that differ are specifically mentioned in these mounting instructions. Open the crate and carefully spread out all the parts on the ground.

1 Safety

1.1 For your safety

Read and observe exactly the safety instructions in this chapter before beginning to assemble the machine.

Anyone involved in the assembly or installation of the machine must read the following mounting instructions very carefully and observe them at all times.

The following symbols can be found where all the important safety instructions appear in these mounting instructions. Strictly follow these instructions and take special care in these cases.



Danger!

This sign signals the danger of accidents or injury leading to death. If you see this safety alert sign in the mounting instructions, make sure you employ every necessary and prescribed safety precaution.



Attention!

This alert sign is a warning of danger of injury during assembly or as a result of installation. It is also a warning against the possibility of damage to equipment or of financial and penal disadvantages (e.g. loss of guarantee rights, product liability etc.).



Note:

Application tips and other useful information.

Incorrect use or mishandling of the machine can endanger:

- life and limb of the operator or other persons or animals who are standing within the vicinity of the machine,
- the machine and other material assets of the owner or third persons,
- the performance of the machine.

1.2 Application as stipulated



Attention!

Those who disregard the regulations mentioned above are acting with gross negligence. In this case the machine manufacturer's liability and warranty no longer applies. The same applies for any resulting damage. The negligent person bears all risks.

This machine may only be assembled by skilled specialists using the valid mounting instructions. The operating instructions and the safety instructions contained therein must be read and strictly complied with prior to coupling the implement to a tractor, transporting the implement or putting the implement into operation.

All relevant accident prevention regulations, as well as all generally recognized safety, health and highway regulations, must be complied with. Personnel assembling the machine must know the regulations and have been thoroughly instructed of the inherent dangers.

Use of the machine for any other purpose is considered operation not in accordance with specifications and is undertaken as such at the owner's risk. The manufacturer is not liable for any resulting damages!

Attention! Never carry out changes yourself; otherwise no warranty will be assumed for resulting damage.

The following regulations must be observed:

- all applicable local accident prevention regulations,
- all recognized traffic, safety and industrial medicine regulations,
- the system limits and safety instructions listed in the technical manual.

1.3 General safety and accident prevention regulations

1. The allocation of responsibility for the various tasks on the machine must be clearly determined and complied with. There may be no uncertainties regarding authority, as these could endanger the safety of the operator.
2. Before operation, make yourself familiar with all elements and controls of the machine, as well as with their function.
3. Work on the machine may only be carried out using suitable tools and apparatus in perfect condition.
4. You may not use any parts (spares, accessories, lubricants etc.) other than those complying with machine manufacturer's requirements. All parts must be used according to the regulations (including the quoted starting torques).

A part complies with the manufacturer's requirements when either genuine or approved by the manufacturer.

5. The operator's clothing should be close fitting. Always wear substantial footwear and recommended protective equipment!
6. When mounting or dismantling the support devices, make sure that they are in the appropriate prescribed position in order to ensure stability!
7. Use caution when working on post-tensioned energy storers such as springs and hydraulic or air pressure aggregates.
8. Discard used oil, grease and filters according to regulations!
9. All protective devices must be installed according to regulations and put in safety position.
10. All operating devices such as ropes, chains, rods, etc. which act on remote-controlled machine elements, have to be installed in such a way that any unintentional movement is excluded in all possible transport and operating positions!

11. Do not leave the engine on within closed spaces (indoors)!
12. Use caution when working on machine elements operated by additional driving systems (e.g. hydraulics). There are squeezing and shearing points!
13. Pay careful attention to the markings on parts with two possible connections or wherever sides could be confused.
14. Always disconnect the power supply (current) before carrying out any work on the electrical system!
15. The generator and battery cables should be disconnected before any electrical welding is carried out on the tractor or the mounted implements!

1.4 General explanation

Observe the legend and torque values listed in the table or specifically mentioned in the mounting instruction text.

Directions quoted („right“, „left“, „in front“, „behind“) are always taken as being in the direction of travel.

The sense of rotation is defined as follows:

- Rotation sense right = clockwise,
- Rotation sense left = anticlockwise,
- Rotations around a vertical axis, taken from top to bottom,
- Rotations around a horizontal axis, at a right angle to the direction of travel, taken from left to right,
- Rotations of nuts, bolts etc. are always taken from the actuation direction.

2.1 Chassis

- Attach the wheel axle to the gearcase
- Use roll pins \varnothing 14x80 and 8x80 (7) to secure the axle.

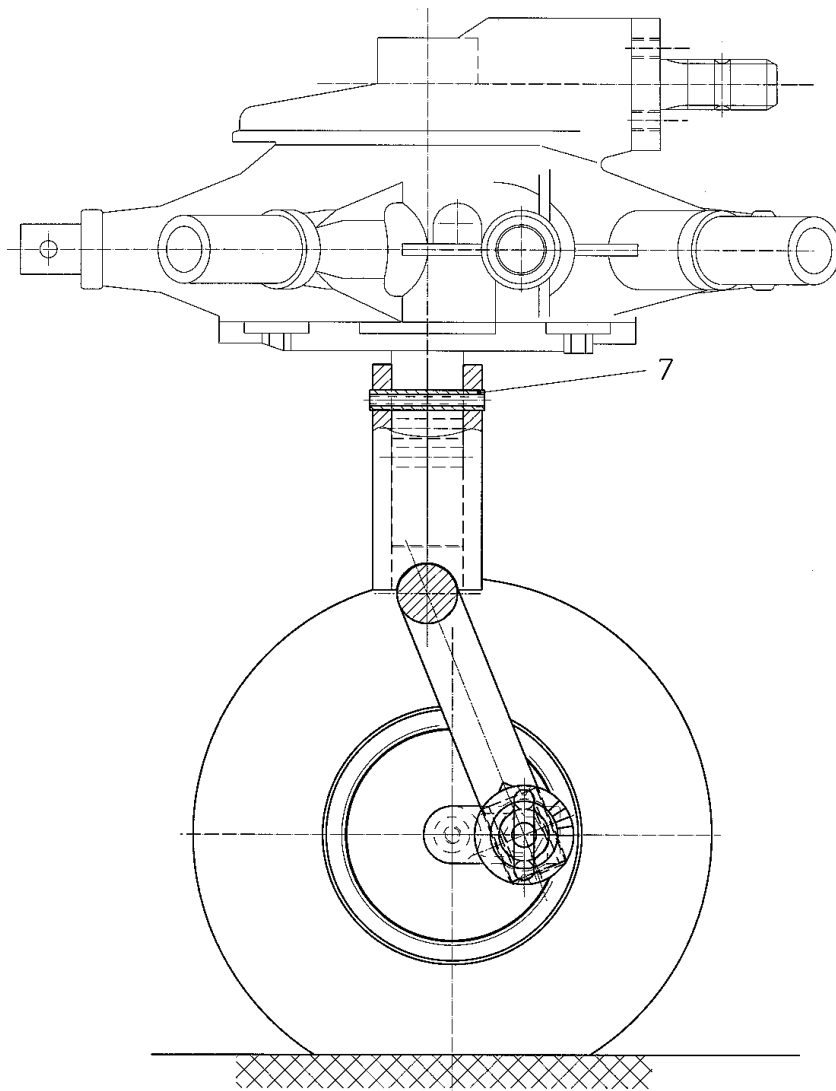

2.2 Chassis

- Fit the wheel, positions 1 to 11 in sequence.

Torque of pos. 7 / M12 nut = 20 Nm!



CAUTION!

Mount the right/left wheels trailing in relation to the direction of travel!

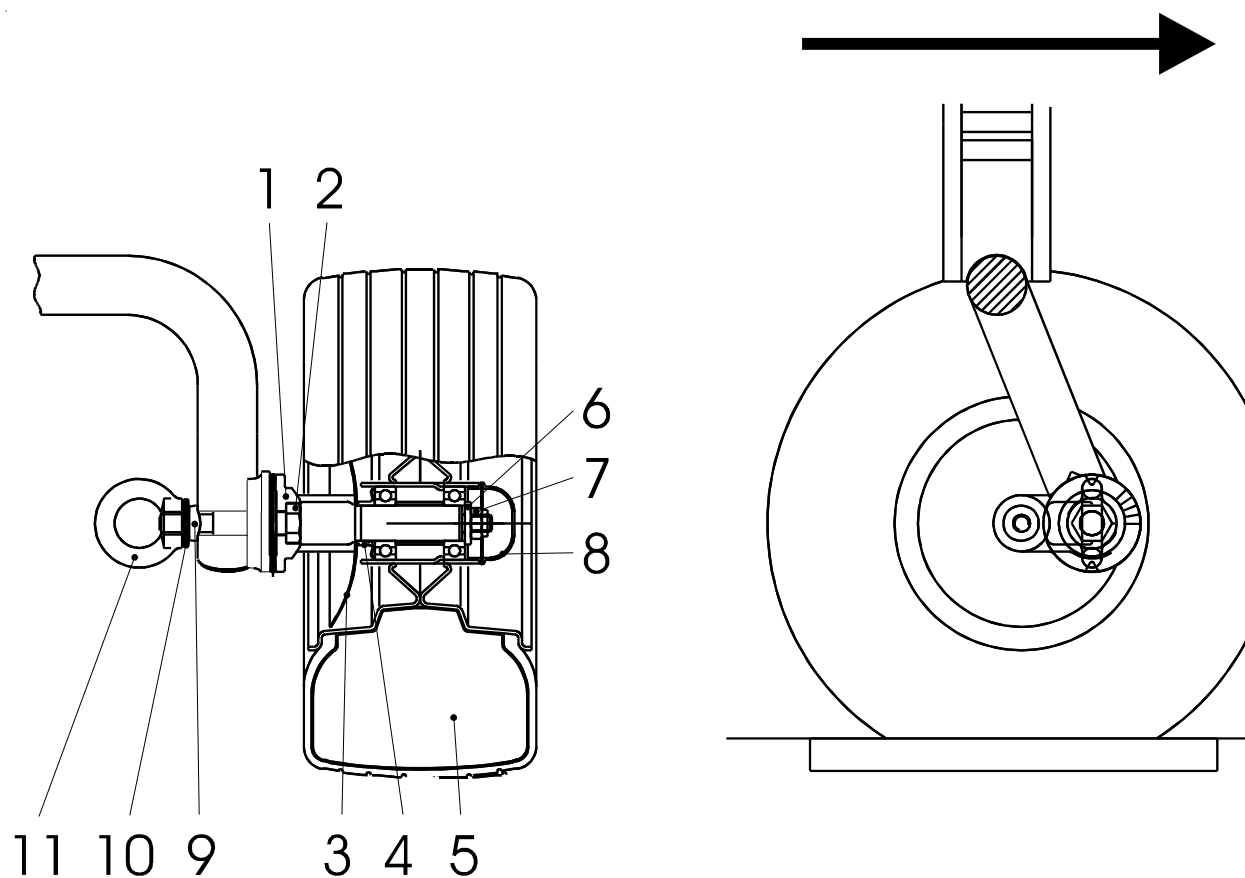

2.3 Lift-arm three-point linkage

- Join the lift arm and three-point linkage.
- Insert the bolt (1), mount the disks (29x42x5) on both sides and secure with cotters.
- Insert the screw (2) M16x110 from above, introduce through tubes, and mount with locking nuts (washers 16x55x4 under screw and nut).
- Install both forks with pins d 20mm, washers and split (3) pins. Observe the direction of installation for cat. I & II.

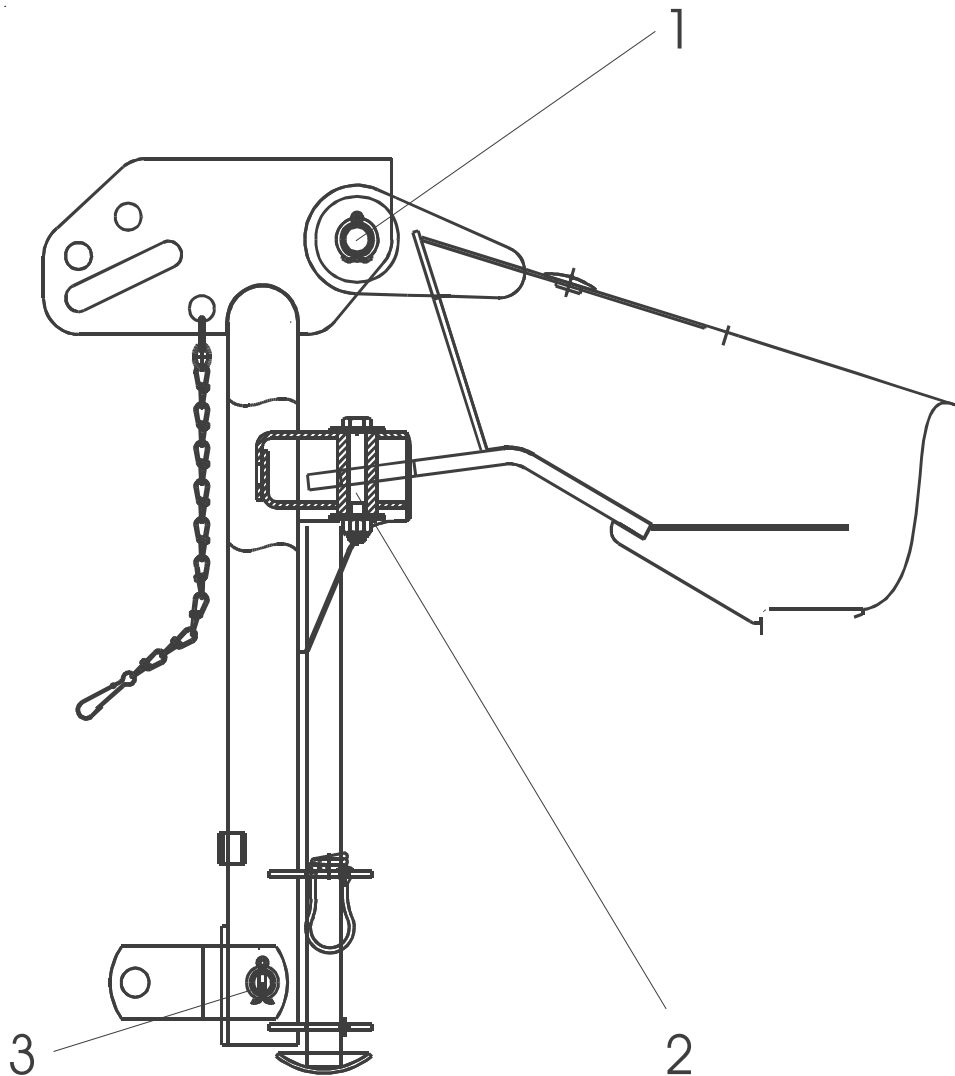

2.4 Mounting the p.t.o. to the implement

- Remove the locking screw (c) located between the guard tube (b) and the funnel (a)
- Twist and turn the funnel (a) and guard tube (b) until the "nose" of the sliding ring (d) lies directly over the openings on the protective funnel (arrows).
- Push the funnel and tube back
- Place the joint (g) on the shaft.
Make sure that it locks in place correctly (f).
- Replace the p.t.o. guard (steps 1-3 in reverse order).

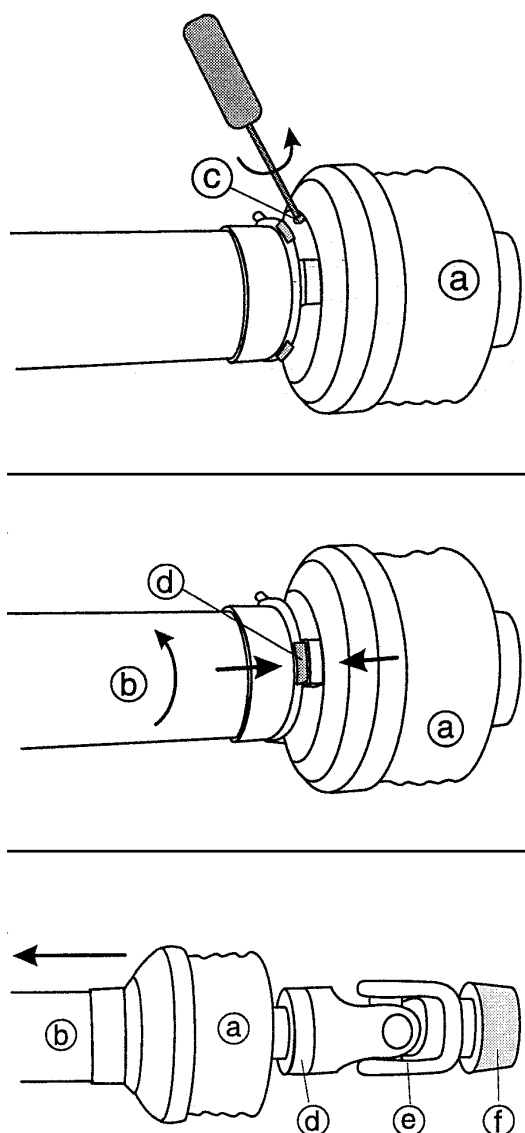

2.5 Guard bow, swath former

- Introduce the guard bow in detail view „X“ (guard hoop with swath former seat on the left-hand side).

- Mount the bearing shells at the front, as indicated in view „Y“

e - shim

f - Screw M 6 x 80

g - Washer 6,4 x 12,5 x 1,6

h - Locking nut M 6

- Mount the parts in detail view „X“ as indicated in the drawing.

- Secure the swath former according to detail view „Z“ with the swath former holder.

a - Locking nut M10 A3C

b - Washer 11,0

c - Washer 10,5 DIN 7349

d - Screw M10 x 30 D933

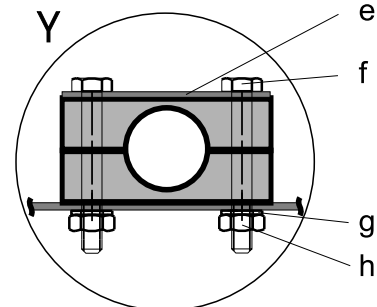
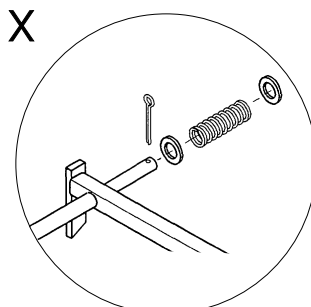
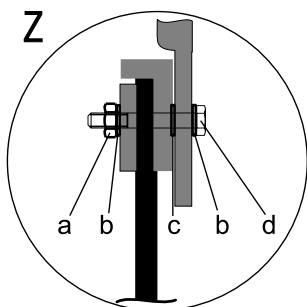
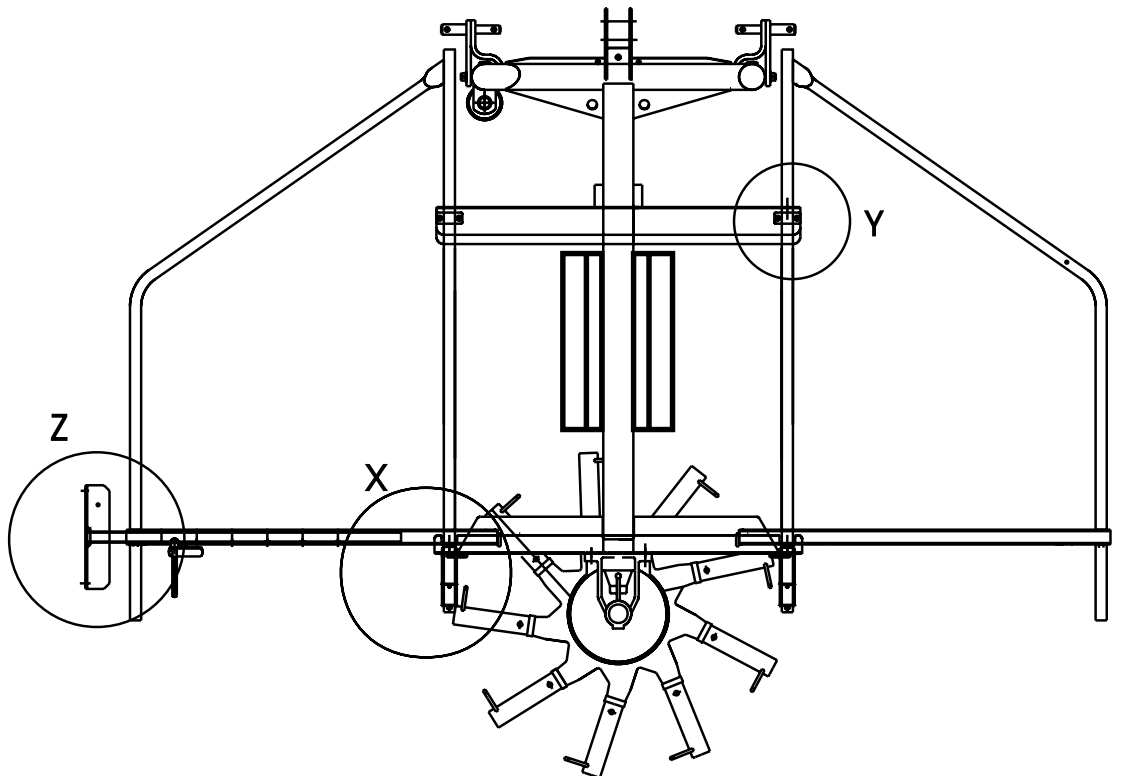

2.6 Tine carrier arms

- Fit thrust washers $\varnothing 35/52/3,5$ to the carrier tubes (gearcase).
- Fit tine carrier arms to the carrier tubes.
- Secure tine carrier arms with bolts M12x75, securing nuts M12 and two shims per arm.
Tightening torque = 110 Nm.

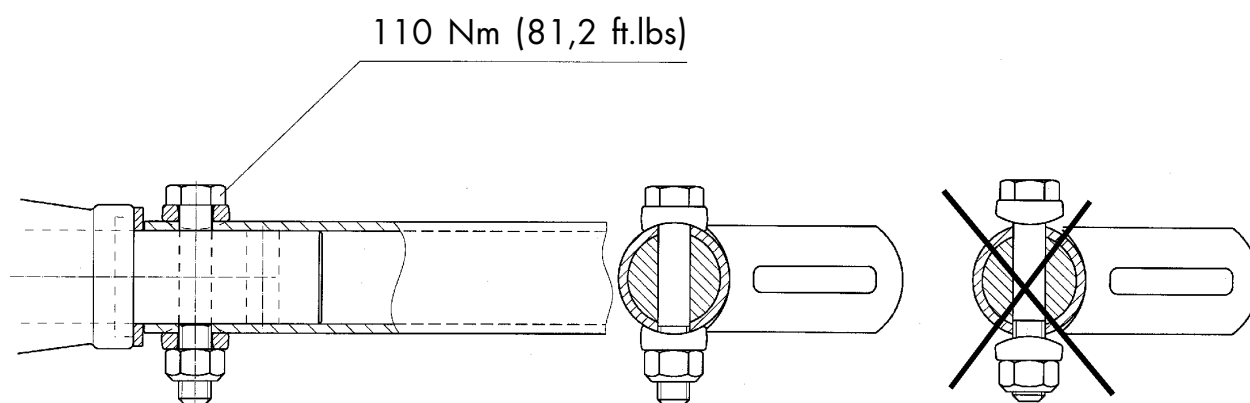

2.7 Screw torques

	8.8	10.9	12.9
M6	9,9 Nm (7,3 ft.lbs)	14 Nm (10,3 ft.lbs)	17 Nm (12,5 ft.lbs)
M8	24 Nm (17,7 ft.lbs)	34 Nm (25 ft.lbs)	41 Nm (30,3 ft.lbs)
M10	48 Nm (35,4 ft.lbs)	68 Nm (50,2 ft.lbs)	81 Nm (59,8 ft.lbs)
M12	85 Nm (62,7 ft.lbs)	120 Nm (88,6 ft.lbs)	145 Nm (107 ft.lbs)
M16	210 Nm (155 ft.lbs)	290 Nm 214 ft.lbs)	350 Nm (258 ft.lbs)

